



SkyView™ Tile

Spec Sheet

bios



DESCRIPTION:

Introducing the SkyView™ Tile by BIOS Lighting. SkyView™ represents the next generation of circadian lighting solutions designed to support the human circadian system during the daytime and evening hours. SkyView™ is a groundbreaking light that can deliver the targeted m-EDI of 250 lux on the vertical plane of the eye, as recommended by both the WELL Building Standard and RP-46-23 from the IES. It's the only luminaire on the market that provides truly immersive circadian lighting while meeting North America's most stringent energy codes. The SkyView™ Tile has two versions: Daylight 0-10 V or Daylight and Evening, which can be operated via 0-10 V or DALI protocol.

SkyView™ LIGHTING SYSTEM FEATURES:

- Offers the highest melanopic ratio of lighting on the market today: 1.1 in daytime mode
- Strengthens circadian rhythms through an electric circadian lighting system with patented GCO™ (Gradient Circadian Optimization) Technology, providing the health benefits of natural sunlight indoors
- Volumetric light distribution maintains uniformity ratios of <2:1
- Proven to boost mood, focus and alertness
- Declare label, Red List Approved
- 0.4 W/ft² on a 10 x 10 grid
- Quick Ship Available on the Daylight Version
- L90 at 60,000 hours





SkyView™ Tile

Spec Sheet

bios

PROJECT: _____

TYPE: _____

PRODUCT ORDERING GUIDE

Example: SVT-2x2-4000lm-DO-SD-MVOLT-QS

SVT — 2x2 — — — MVOLT — — —

Product ID	Fixture Type	Lumen Output
SVT: SkyView™ Tile	2x2	3000 lm
		4000 lm
		5000 lm

Day/Night/Dimming Interface	Voltage	Shipping
DO - SD: Day only with 0-10 V Dimming	MVOLT: 120 - 277 V	QS: Quick Ship (available only for 4000 lm, day only with 0-10 V Dimming)
DBN - SD: Day/Night with Bio-dimming; single channel 0-10 V Dimming		
D2N - DALI: Day/Night 2 channel: DALI - 2 DT8	347 V* - consult the factory	ST: Standard Lead Time
Lutron* - consult the factory		

Color	Mounting	Add-on Options* - consult the factory
Leave blank for White	Standard is Recessed for ACT	Emergency Back Up
	Pendant* - consult the factory	Emergency Bypass
BLK: Black	Surface* - consult the factory	Integrated Controls

COLOR QUALITY

CRI	≥ 90
R9	≥ 90
TM-30	
Rg	102
Rf	90

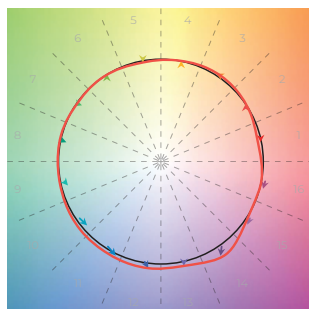

LIGHT PERFORMANCE

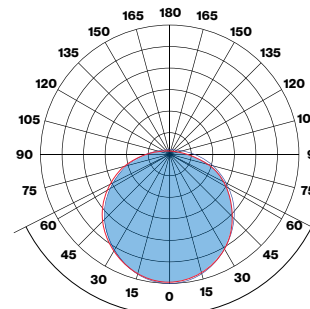



SkyView™ Tile

Spec Sheet

bios

DIMENSIONS

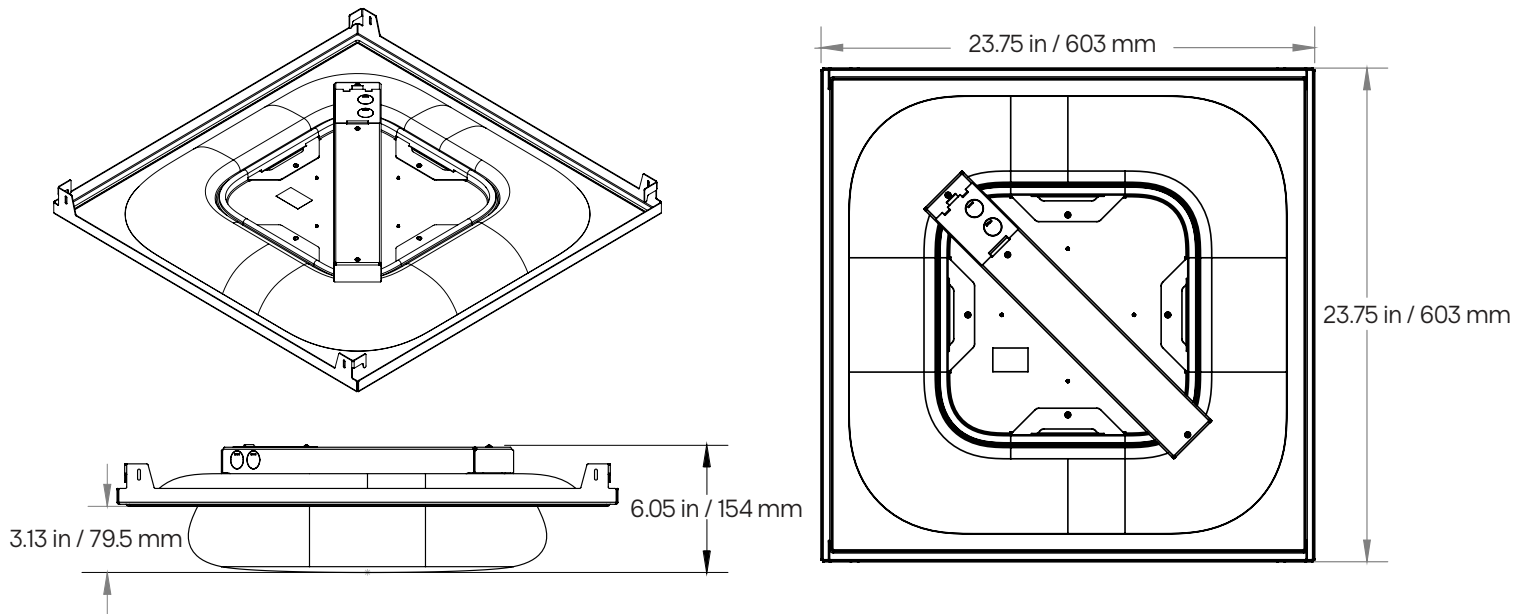

LIGHTING LAYOUT

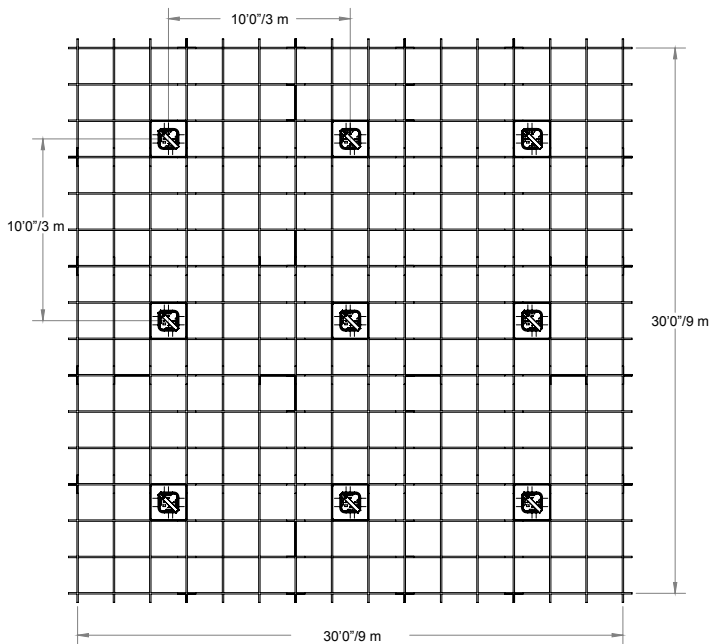

Example placement of 4000 lumen fixture on a 9' / 2.74 m ceiling, achieving 30 FC / 300 lux task plane luminance and 250 melanopic equivalent daylight illuminance (m-EDI).

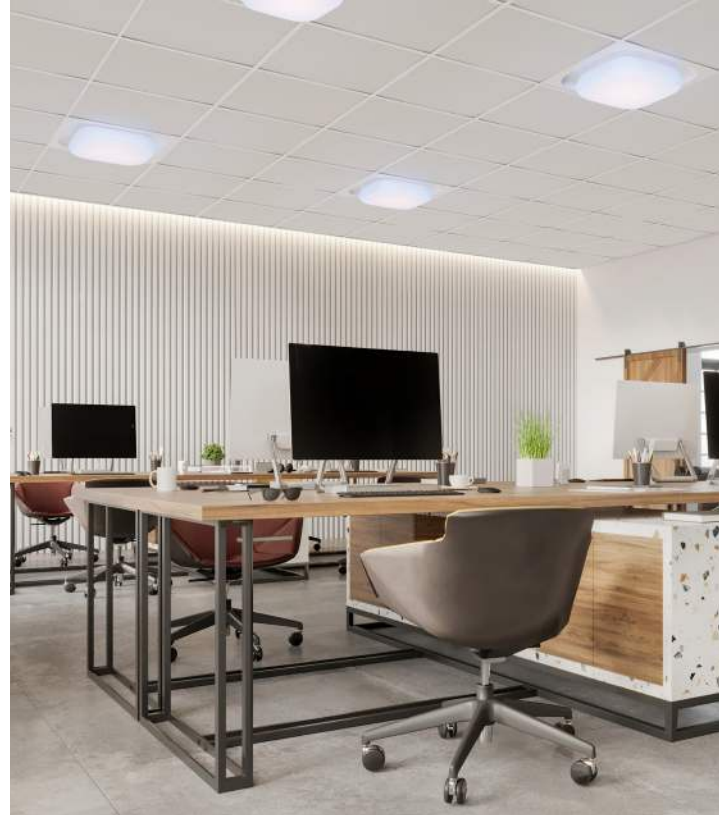



SkyView™ Tile

Spec Sheet

bios

TECHNICAL SPECIFICATIONS

CONSTRUCTION

- Formed 23 ga. steel housing
- Universal T-bar clips, seismic restraint tabs/tie-offs
- High reflectance diffuser white matte powder coat

OPTICAL

- Patented SkyView™ GCO™ (Gradient Circadian Optimization) Technology light engine
- Precision molded high transmittance LLDPE plastic diffuser that is recyclable
- Long-life LED system designed for typical TM21 lumen maintenance \geq L90 @ 60,000 h
- Available in 3000, 4000 and 5000-lumen packages with CRI \geq 90 and R9 \geq 80, all with color-accurate binning \leq 2 SDCM

ELECTRICAL

- Integral high-efficiency drivers for 50–60 Hz, 120–277 V
- Power Factor > 0.90
- Total Harmonic Distortion $< 20\%$
- Dim level: Standard dim to dark 100-3% with Day/Evening 100-0.01%
- Surge Protection: Meets ANSI C82.11 spec and ANSI/IEEE C62.41
- Inrush Current: Meets NEMA 410

EMERGENCY

- The Optional Battery Pack delivers 10 W Class 2-rated output for 90 min. It uses 12 W input energy to estimate emergency flux, typically 1150–1750 lm (@ 100–150 lm/W).

- Optional GTD (Generator Transfer Switch), 120–277 V, disables 0–10 V control during an emergency for total light output

ENVIRONMENT

- Designed for use in dry or damp indoor locations with ambient temperatures of 0–30 °C or 32–86 °F IP22 rating
- Not suitable for natatorium environments.

CARE

- Clean only with a slightly water-damp, soft, clean cloth.

WEIGHT

- Maximum 10 lbs (4.54 kg) with standard driver
- Maximum 14 lbs (6.35 kg) with battery pack

WARRANTY

- 5-year limited warranty on all components and workmanship

INDEPENDENT TESTING

- IESNA LM79
- IESNA LM80 (LED @ 9,000 or 10,000 h)

APPROVALS

- UL Listed (USA + Canada)
- RoHS Certificate of Conformity